

FEATURES AND BENEFITS

Product Summary		
I_o	100mA	@25 °C
V_F	1.2V	@100mA
V_{RRM}	90V	@25 °C

- For General Purpose Switching Applications
- High Conductance
- RoHS Compliant / Green EMC UL Flammability Classification Rating 94V-0
- Matte Tin (Sn) Lead finish Solderable per MIL-STD-202, Method 208
- Moisture Sensitivity: Level 1 per J-STD-020
- Weight: 0.004 grams (Approximate)

SOD-323

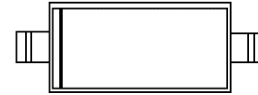

Cathode  Anode

Maximum Ratings (TA = 25 °C unless otherwise noted)

PARAMETER	SYMBOL	VALUE	UNIT
Repetitive Peak Reverse Voltage	V_{RRM}	90	V
Working Reverse Voltage	V_{RWM}	80	V
Repetitive Peak Forward Current	I_{FRM}	225	mA
Average Rectified Output Current	I_o	100	mA
Non-Repetitive Peak Forward Surge Current (@t=1.0us)	I_{FSM}	2.0	A
Power Dissipation	P_{TM}	200	mW
Junction Temperature	T_J	150	°C
Storage Temperature	T_{STG}	-55 to +150	°C

ELECTRICAL CHARACTERISTICS (TA = 25 °C unless otherwise noted)

PARAMETER	SYMBOL	CONDITION	MIN	MAX	UNIT
Forward Voltage	V_F	$I_F = 100mA$		1.2	V
Reverse Current	I_R	$V_R = 80V$		0.1	μA
Capacitance	C_T	$V_R = 0V, f = 1MHz$		3.0	pF
Reverse Recovery Time	t_{rr}	$I_F=10mA, V_R=6V, R_L=100\Omega$		4	ns

RATING AND CHARACTERISTICS CURVES

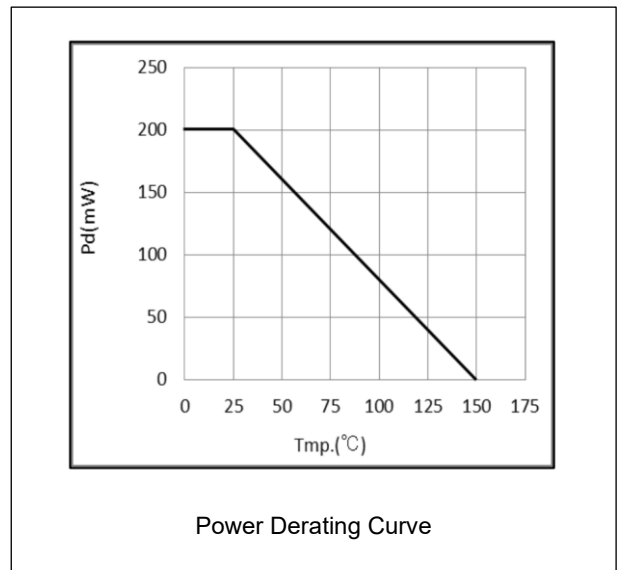
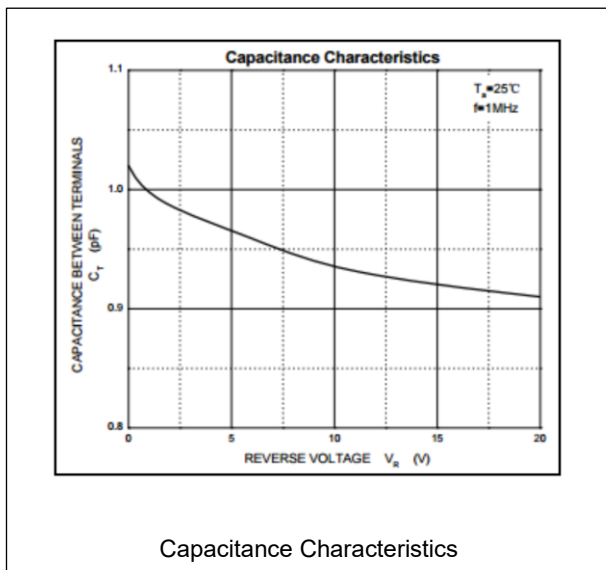
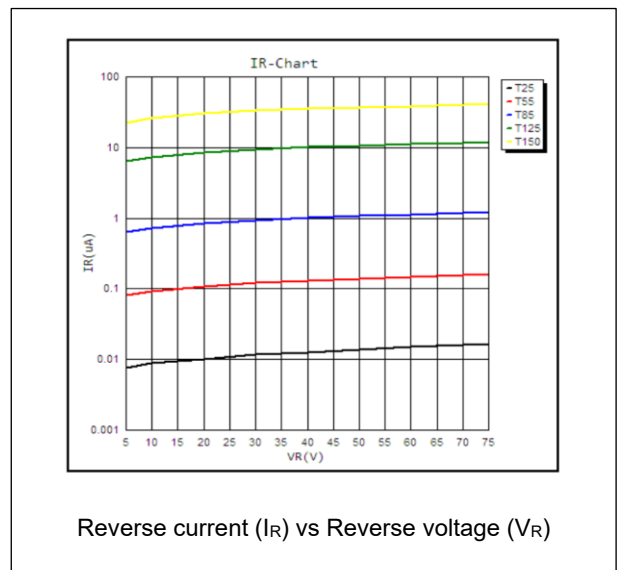
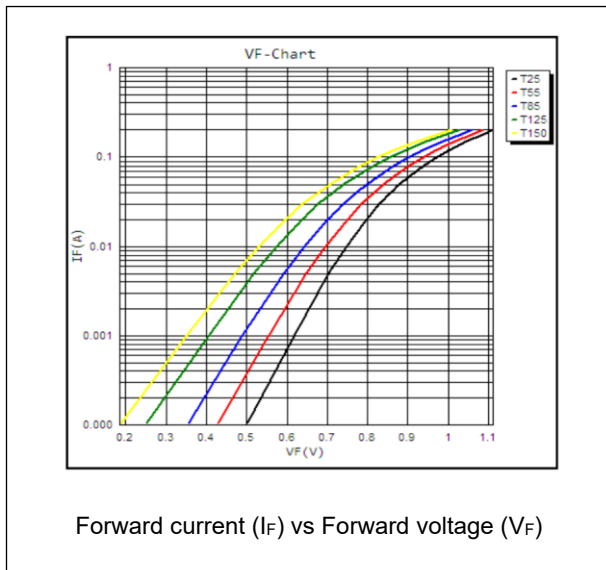

PACKAGE OUTLINE DIMENSIONS

SOD-323

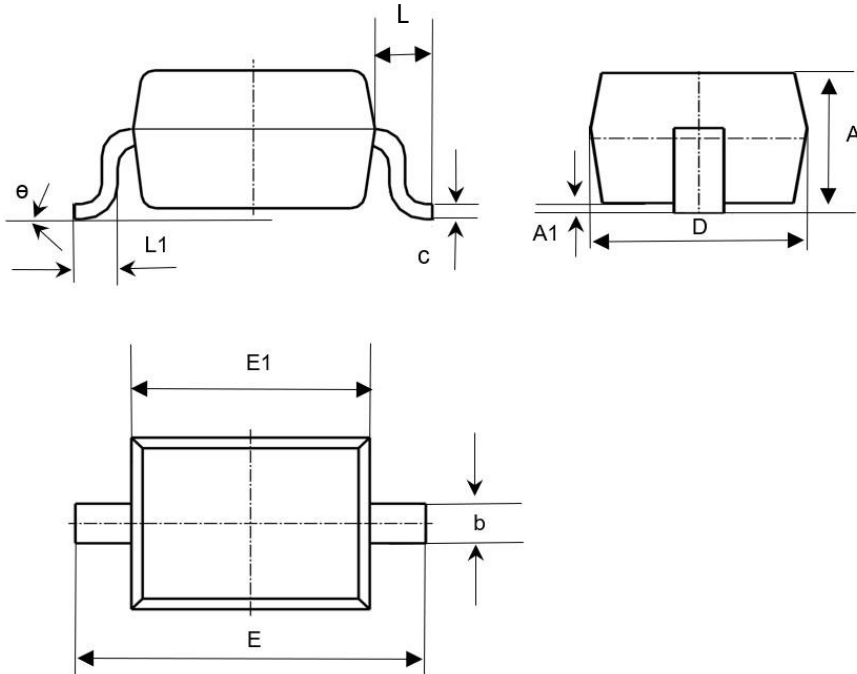

Symbol	MIN	MAX
A	-	1.00
A1	0.00	0.10
b	0.25	0.35
c	0.08	0.15
D	1.20	1.40
E	2.50	2.70
E1	1.60	1.80
L	0.475REF	
L1	0.25	0.40
θ	0°	8°
Unit: mm		

SUGGESTED PAD LAYOUT

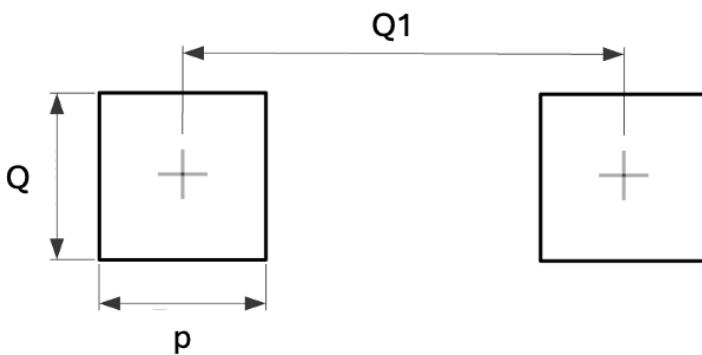

Symbol	Typ
Q1	2.15
Q	0.7
p	0.7
Unit: mm	

DEVICE MARKING CODE AND ORDERING INFORMATION

DEVICE	Marking	Quantity	Packing
1SS355WS	A	3000/7"Reel	Tape & Reel

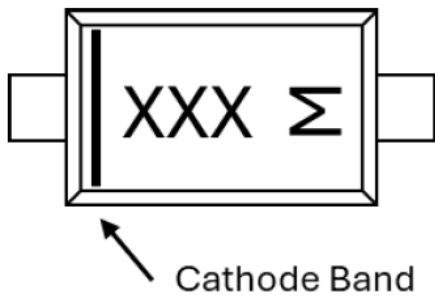

XXX: Product Marking Code

Σ : Date Code (Rotate 90° counterclockwise)

Odd Year	Even Year
1	E
2	F
3	H
4	J
5	K
6	L
7	N
8	P
9	U
T	X
V	Y
C	Z

NOTICE:

AZUREMOTO'S PRODUCTS ARE NOT AUTHORIZED FOR USE AS COMPONENTS IN ANY LIFE SUPPORT DEVICES OR SYSTEMS. AZUREMOTO RESERVES THE RIGHT TO MAKE CHANGES WITHOUT FURTHER NOTICE TO ANY PRODUCTS HEREIN TO IMPROVE RELIABILITY OR RUGGEDNESS.